

SCREW TOGETHER HOODS, TOP ENTRY

C88E000 SERIES

Northern Technologies

TECHNICAL SPECIFICATIONS

Material: Zinc, Nickel Plated
 Operating temperature: -25°C to +90°C
 Cable entry: Top Entry
 Thumbscrews: UNC 4-40



Size	Product Code - Top Entry
9-way	C88E000209
15-way	C88E000211
25-way	C88E000204
37-way	C88E000210
50-way	C88E000212

Size	Dim A	Dim B	Dim C	Dim D
9-way	31,1	37,2	15,7	15,7
15-way	39,1	40,6	15,7	15,7
25-way	53,1	39,1	17,5	15,7
37-way	66,6	45,7	21,9	18,5
50-way	66,6	45,7	21,9	18,5

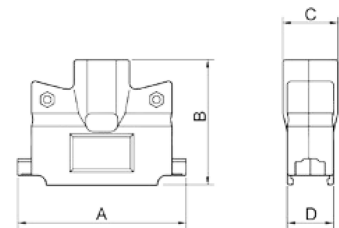

SCREW TOGETHER HOODS, 90° ENTRY

N30E9 SERIES

Northern Technologies

TECHNICAL SPECIFICATIONS

Material: Zinc, Nickel Plated
 Operating temperature: -25°C to +90°C
 Cable entry: 90° Entry
 Thumbscrews: UNC 4-40
 Cable diameter: Up to 18.4 mm
 Type of grommets: Compression Inserts



FEATURES

- Available in sizes 9-15-25-37-50
- Suitable for any common Sub-D connector
- Re-openable
- Compression Inserts in Thermoplastic Compound

Size	Product Code
9-way	N30E900000
15-way	N30E910000
25-way	N30E920000
37-way	N30E930000
50-way	N30E940000

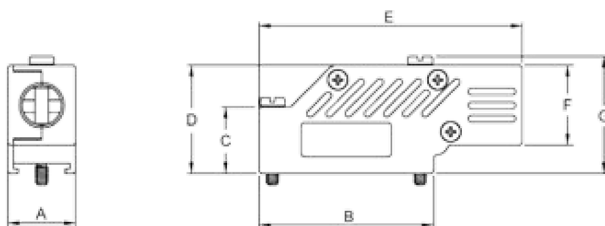

Compression Inserts - Inner Diameters:

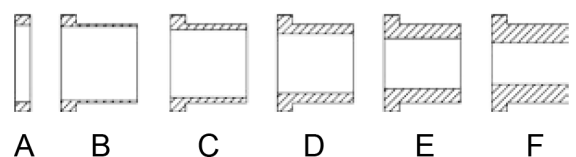

Size	A	B	C	D	E	F	G
9-way	15,0	30,8	15,0	24,4	50,8	18,0	26,2
15-way	15,2	39,4	15,0	24,4	59,3	18,0	26,4
25-way	15,8	53,3	23,1	34,5	72,4	24,3	35,0
37-way	15,8	69,9	23,1	40,9	89,7	30,7	42,9
50-way	18,0	67,1	-	40,9	86,9	30,7	42,9

Size	A	B	C	D	E	F
9/15 way	8,10	8,00	7,25	6,50	5,30	-
25-way	11,40	10,40	9,40	7,60	5,80	-
37/50-way	16,50	15,75	14,50	12,70	10,80	8,90