

SA16 Series

**SA
16**



Cable connector
Mate with SA1611, SA1612,
SA1613, SA1615

SA1610/P --- SA1610/S
Male contact
Female contact
Number of contact
Cable outer diameter
I: 5-8mm, II: 8-12mm

1: solder, 3: crimp

Colour:
B: Black
S: Silver
L: Blue (special order)
G: Green (special order)
R: Red (special order)

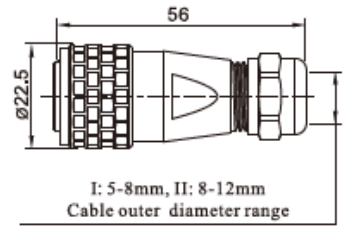

SA1611/P --- SA1611/S

In-line cable connector
Mate with SA1610

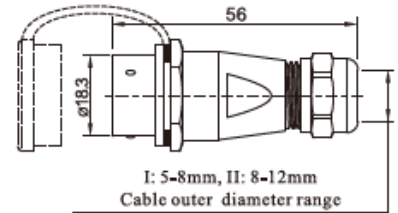

SA1612/P --- SA1612/S

Number of contact

Rear-nut mount
Mate with SA1610

1: solder, 3: crimp
Colour

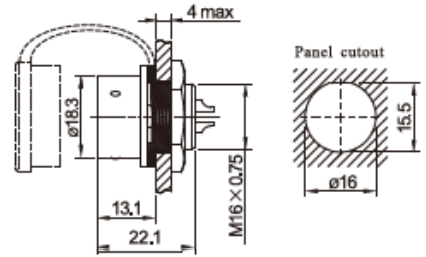

SA1613/P --- SA1613/S

Square flange
Mate with SA1610

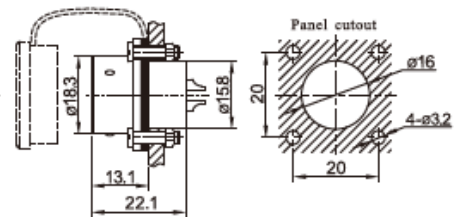
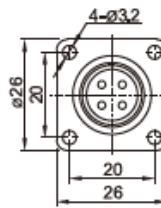

SA1615/P --- SA1615/S

Front-nut mount
Mate with SA1610

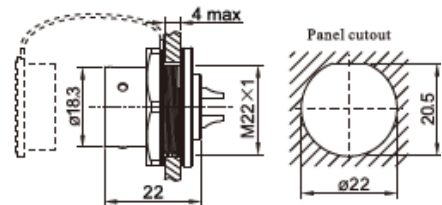

Solder contact spec

Number of contact	2	3	4	2B	3B	4B	5	7	9	10
Male contact face view										
Rated current (A)	10	10	5	15	15	15	5	5	5	5
Contact diameter(mm)	Ø1.5X2	Ø1.5X3	Ø1X4	Ø2X2	Ø2X3	Ø2X4	Ø1X5	Ø1X7	Ø1X9	Ø1X10
Rated voltage (AC.V)	500	500	500	500	500	500	500	400	400	400
Test voltage(AC.V) 1 min	1500	1500	1500	1500	1500	1500	1500	1200	1200	1200
Contact resistance (mΩ)	2.5	2.5	5	2.5	2.5	2.5	5	5	5	5
Wire size (mm²/AWG)	≤2/14	≤2/14	≤0.75/18	≤2/14	≤2/14	≤2/14	≤0.75/18	≤0.75/18	≤0.75/18	≤0.75/18