

### IDC HEADER PLUG (TRANSITION) 2.54mm PITCH

#### TECHNICAL SPECIFICATIONS

##### Material

Insulator : Black PBT, glass reinforced, rated UL 94V-0

Contact : Selective Gold Plated Brass

##### Electrical

Current Rating : 1 Amp

Contact Resistance : 30 mΩ max.

Insulation Resistance : 3000 MΩ min.

Dielectric Withstanding Voltage : 500V AC for 1minute

Operating Temperature : -40°C to +105°C

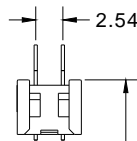
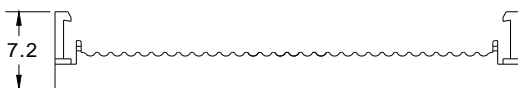
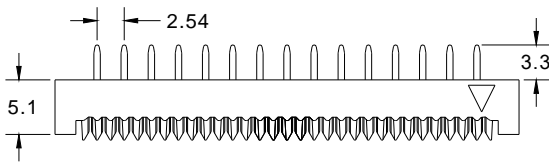
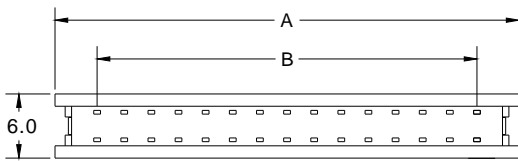

(7.4)  
TERMINATED  
HEIGHT

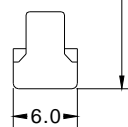

POSITION	A	B
6	12.96	5.08
8	15.50	7.62
10	18.04	10.16
12	20.58	12.70
14	23.12	15.24
16	25.66	17.78
20	30.74	22.86
24	35.82	27.94
26	38.36	30.48
28	40.96	33.02
30	43.44	35.56
34	48.52	40.64
40	56.14	48.26
50	68.84	60.96
60	81.54	73.66
64	86.62	78.74

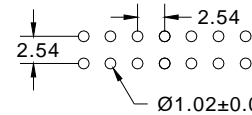

RECOMMENDED P.C.B. LAYOUT

#### Ordering Information

Part no example:

PTB 10

**SERIES**

**SIZE**

6, 8, 10, 12, 14, 16, 20, 24, 26, 30, 34, 40, 50,  
60, 64